

Ansicht:

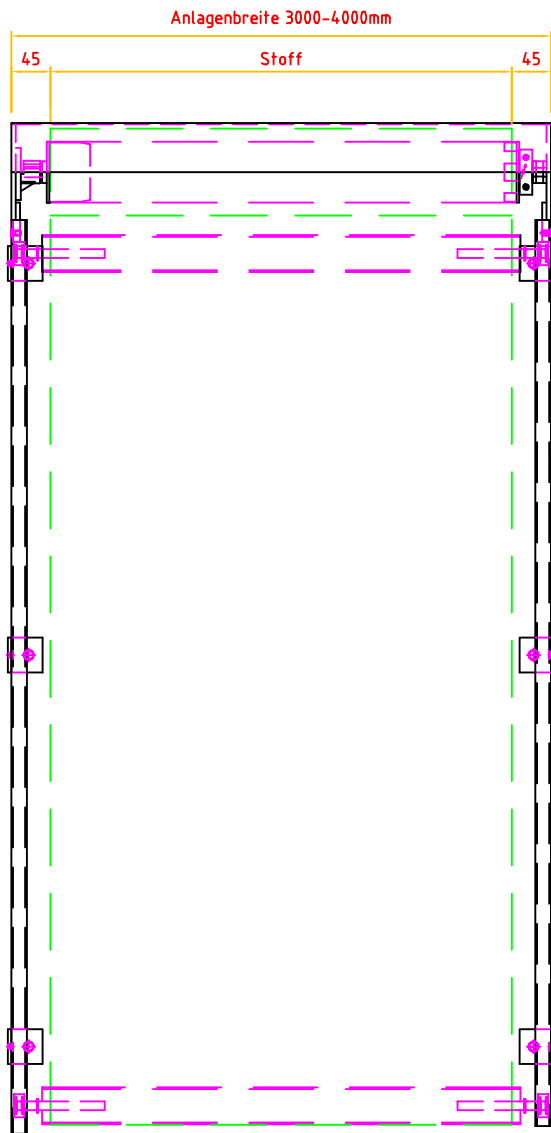

Vertikalschnitt:

Anlagenbreite von 3000-4000mm

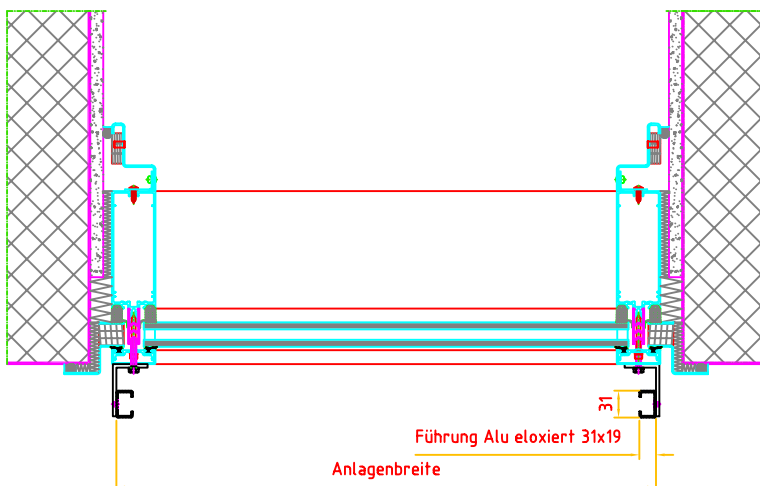
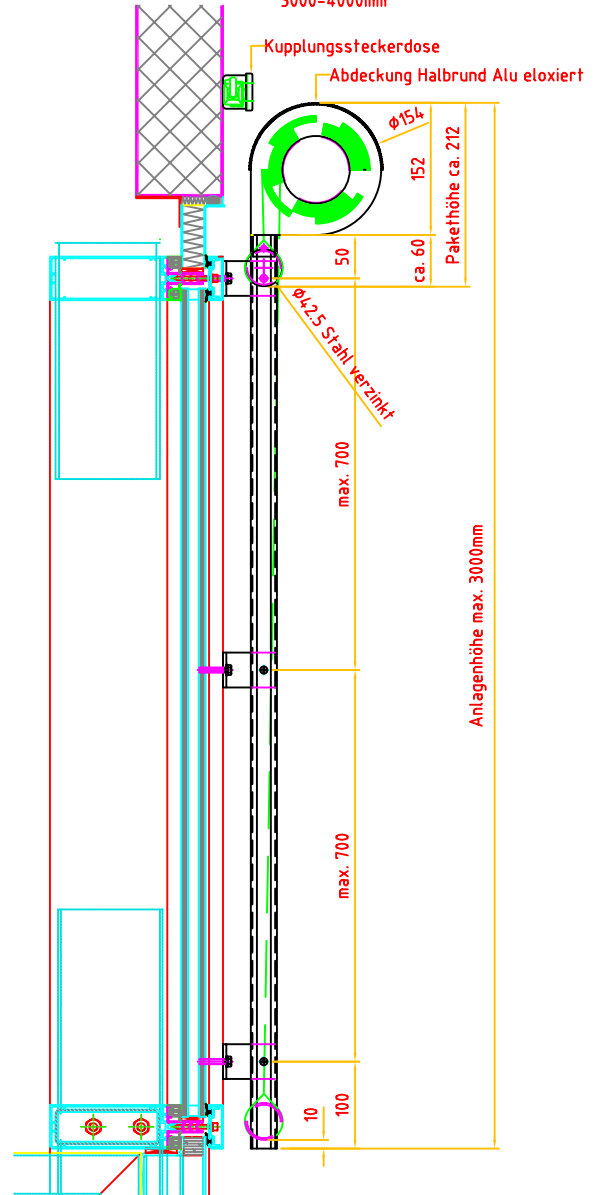

# STORAMA AG

Pfandersmatt  
 3664 Burgstein  
 Tel. 033 359 80 80 Fax 033 359 80 70

Dat. Nr.3.4\_vertikal\_c

Bearbeitet AS / PR	Datum Sept. 2007	Rev. Datum	Maßstab
-----------------------	---------------------	------------	---------

Standard Plan, Motorbedienung  
 Vertikal-C, Fassadenmontage

Ansicht, Vertikal-und Horizontalschnitt Breiten 3000-4000	Plan Nr. cdr.vertikal.c.a4.02
--	----------------------------------